



Telescopic three piece zinc plated pump handle.



The BRD50 and BRD100 jacks are fitted with two pumps (approach and operation).



Rotatory carrying handle from BR20 onwards.



BUREAU VERITAS

Complies with:
American ANSI PALD
Australian / New Zealand Standard
CE official certification

HYDRAULIC BOTTLE JACKS
Telescopic three piece zinc plated pump handle.
Rotatory pump socket. It can be operated from any position.
Rotatory carrying handle keeps retracted telescopic lever.
Extension screw provides added lifting height.
Safety overload valve which prevents the jack from being used beyond its rated capacity.
Safety oil by-pass system prevents the ram from being over extended and causing damage to the cylinder.
Pump handle can be locked.



The BRD100 model includes a pressure gauge.



Hydraulic bottle jacks

Rotatory pump socket. It can be operated from any position.

BR10

BR20

BR30

BR50

BRD50

BRD100



Safety overload valve. Up to 5t, **OPTIONAL**.



Hydraulic stroke limitation.

The MEGA jacks can be used horizontally when required.

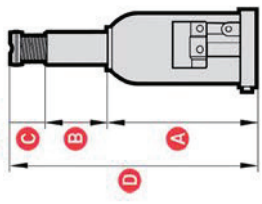
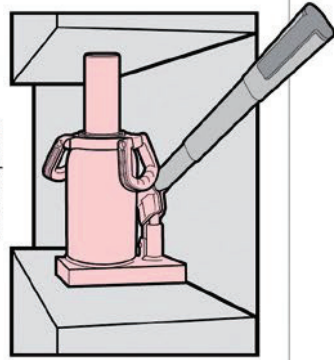

CAPACITY (t)	2	3	3	5	8	10	12	15	20	25	30	40	50	50	100
A	168	168	210	212	219	219	226	228	234	242	242	246	260	260	300
B	105	105	150	150	150	150	150	150	150	150	150	150	140	140	150
C	65	65	65	75	75	75	75	75	75	75	75	-	-	-	-
D	338	338	425	437	444	444	451	453	459	467	467	396	400	400	450
Weight (kg)	3,6	3,7	4	4,5	6,2	6,4	8,5	8,8	10,6	15,5	15,5	22,5	27	30	87
REFERENCES	BR2	BR3	BR3A	BR5	BR8	BR10	BR12	BR15	BR20	BR25	BR30	BR40	BR50	BRD50	BRD100

Measures in mm.